



**SPITZNAS**  
CUSTOMIZED POWER SOLUTIONS



# PIPE CUTTING MACHINES

TOOLS FOR THE SPECIALIST

PNEUMATIC



HYDRAULIC



ATEX



# SYSTEM CONCEPT



Tool holder



Air connection  
with sensor block



Adjustment for the  
cutting depth

ATEX-Safety class  
approved



Guard



Pneumatic or hydraulic  
drive unit

Cooling water connection

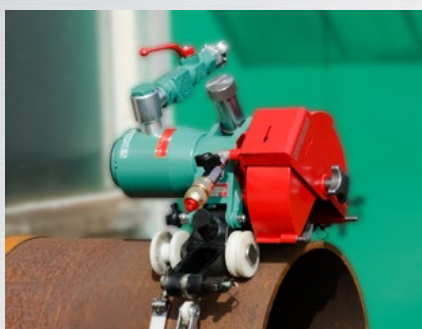

## PNEUMATIC DRIVE UNIT

The pneumatic drive unit with two gear steps for **cutting and bevelling** for pipes made of different material, as:

- Ductile iron
- Concrete
- Cement
- Clay
- Non-ferrous metal
- Plastics
- PE
- PVC
- GRP

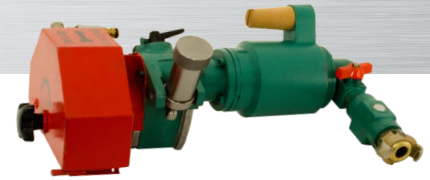

ORDER NO.	ATEX Specification	PNEUMATIC		OPER. PRESSURE		ATEX		Height	Noise level LpA	Vibration level	Weight	
		Power	Air consumption	Blade dia. max.	Tool holder	6 Bar	Speed (free) Gear1					Speed (free) Gear 2
		kW	m <sup>3</sup> /min	mm	mm	rpm	rpm	mm	mm	dB(A)	m/s <sup>2</sup>	kg
<b>5 8002 7000</b>	II2GExhIIBT6Gb	1.8	2.2	180	22.2/30.0	1,800	350	50	250	98	<2.5	13.0

Subject to technical change.

Performance data at an operating pressure of 6 bar.

## PNEUMATIC DRIVE UNITS

The pneumatic drive unit with high torque for **cutting steel pipes** can be used as well for:

- Steel
- Stainless steel
- PE
- Concrete
- Cement
- Non-ferrous metal
- Plastics
- Ductile iron
- PVC
- GRP
- Clay



ORDER NO.	ATEX Specification	PNEUMATIC		OPER. PRESSURE		ATEX		Height	Noise level LpA	Vibration level	Weight
		Power	Air consumption	Blade dia. max.	Tool holder	6 Bar	Speed (free)				
		kW	m <sup>3</sup> /min	mm	mm	rpm	mm	mm	dB(A)	m/s <sup>2</sup>	kg
<b>5 8010 0050</b>	II2GExhIIBT6Gb	2.4	3.0	180	22.2/30.0	1,800	50	250	98	<2,5	12.5
<b>5 8011 0050</b>	IM2ExhIMbT6	2.4	3.0	180	22.2/30.0	1,800	50	250	98	<2,5	17.5

Subject to technical change.

Performance data at an operating pressure of 6 bar.

## HYDRAULIC DRIVE UNITS

The hydraulic unit with two gear steps/stepless adjusting for **cutting or bevelling** pipes of the following materials:

- Steel
- Stainless steel
- PE
- Concrete
- Cement
- Non-ferrous metal
- Plastics
- Ductile iron
- PVC
- GRP
- Clay

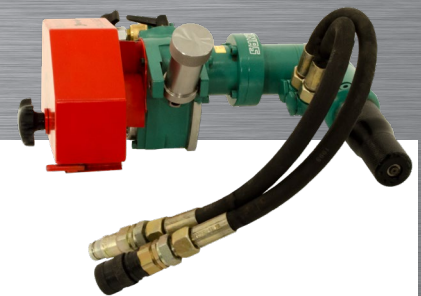

ORDER NO.	ATEX Specification	HYDRAULIC		OPER. PRESSURE		ATEX		Height	Noise level LpA	Vibration level	Weight	
		Power	Volume flow	Blade dia. max.	Tool holder	90-140 bar <sup>1)</sup> /140-180 bar <sup>2)</sup>	Speed (free) Gear1					Speed (free) Gear 2
		kW	l/min	mm	mm	rpm	rpm	mm	mm	dB(A)	m/s <sup>2</sup>	kg
<b>5 8006 7000<sup>1)</sup></b>	II2GExhIIBT6Gb	2.0	15-50	180	22.2/30.0	950	200	50	250	98	<2.5	13.0
<b>5 8016 0050<sup>2)</sup></b>	II2GExhIIBT5Gb	2.3	20-23	180	22.2/30.0	0-1,050*		50	250	98	<2.5	14.9

Subject to technical change.

<sup>2)</sup>steplessly adjustable

Performance data at an operating pressure of 90<sup>1)</sup> bar/140<sup>2)</sup> bar.

# TECHNICAL DATA

# SYSTEM ACCESSORIES

## ASSEMBLY PARTS

Just specify your individual application and we custom-assemble your pipe cutting machine with the required accessories.

Pipe dia. / ORDER NO. [mm]	Guide carriage small	Guide carriage large	Chain tensioner	Tensioning chain	Guide chain
300-400	1 x 5 8010 8090		1 x 5 8003 8300		1 x 5 8002 8760
400-800	1 x 5 8010 8090	1 x 5 8010 8100	1 x 5 8002 8400	1 x 5 8002 8710	1 x 5 8002 8780
600-900		2 x 5 8010 8100	2 x 5 8002 8400		1 x 5 8002 8810
400-1400	1 x 5 8010 8090	2 x 5 8010 8100	2 x 5 8002 8400	1 x 5 8002 8710	1 x 5 8002 8820
400-1600	2 x 5 8010 8090	2 x 5 8010 8100	2 x 5 8002 8400	2 x 5 8002 8710	1 x 5 8002 8830

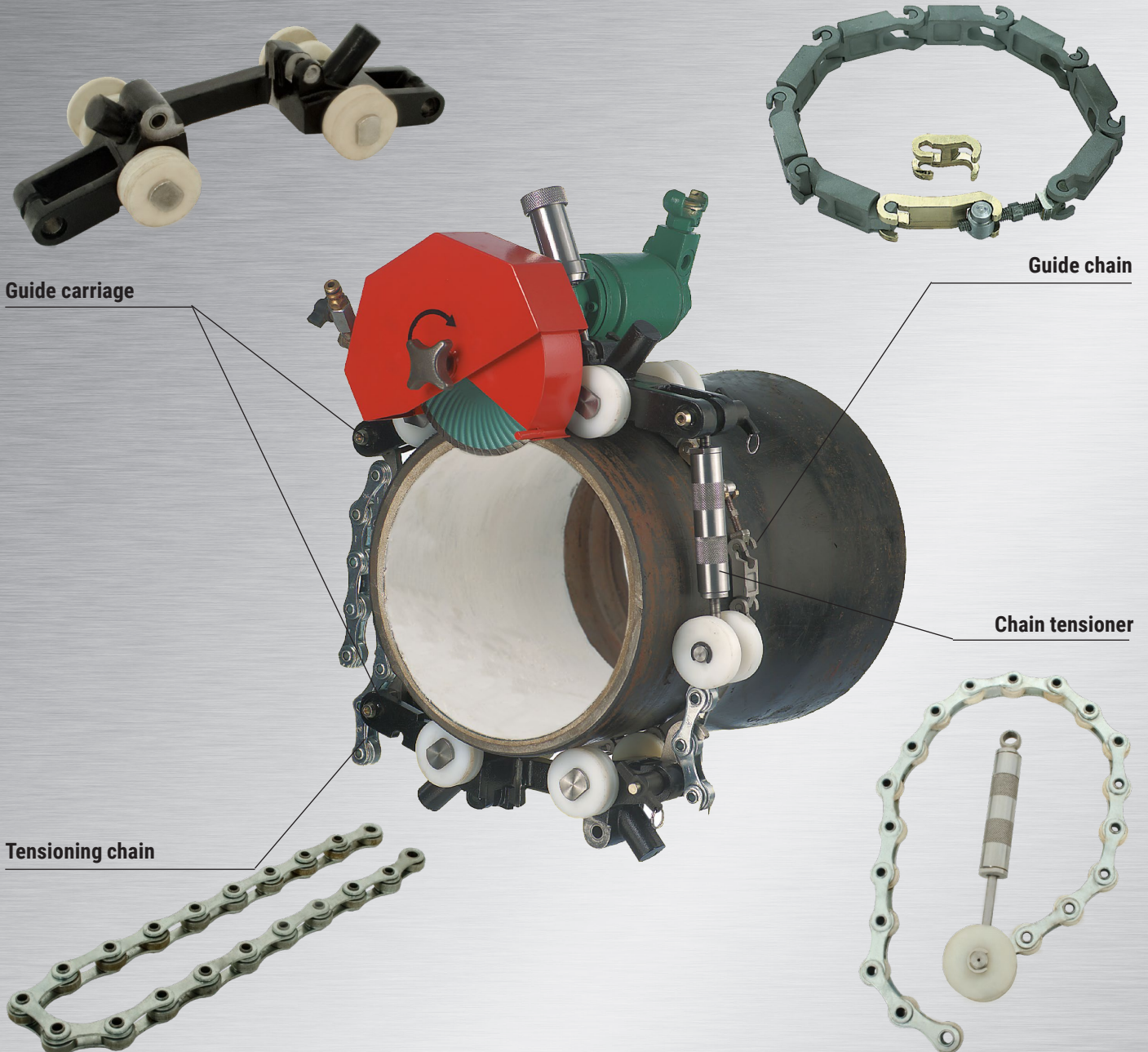

## GUIDE CARRIAGES

ORDER NO.	Pos.	Description
5 8010 8090	1	Guide carriage small (aluminium)
5 8011 8090	1	Guide carriage small (zamak)
5 8010 8100	2	Guide carriage large (aluminium)
5 8011 8100	2	Guide carriage (zamak)

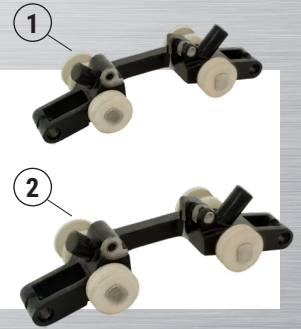

## GUIDE CHAINS

ORDER NO.	Description	For pipe dia. [mm]
5 8002 8760	Guide chain including tightener and 24 chain links	≤ 400
5 8002 8770	Guide chain including tightener and 35 chain links	≤ 600
5 8002 8780	Guide chain including tightener and 46 chain links	≤ 800
5 8002 8810	Guide chain including tightener and 57 chain links	≤ 1000
5 8002 8790	Guide chain including tightener and 68 chain links	≤ 1200
5 8002 8820	Guide chain including tightener and 79 chain links	≤ 1400
5 8002 8830	Guide chain including tightener and 90 chain links	≤ 1600



## TIGHTENER

ORDER NO.	Description
5 8002 6800	Tightener

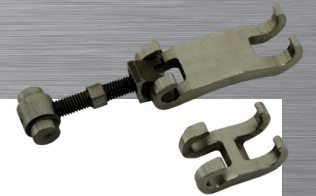

## CHAIN LINKS

ORDER NO.	Pos.	Description
5 8001 8750	1	Chain link, length 57 mm
5 8001 8760	2	Chain link, length 57 mm, with magnet
5 8001 8860	3	Chain link set (set of 5 pieces, preassembled)
5 8001 8960	3	Chain link set (set of 6 pieces, preassembled), with magnet

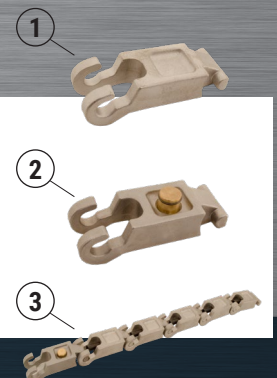

# SYSTEM ACCESSORIES

# SYSTEM ACCESSORIES

## TENSIONING CHAIN

ORDER NO.	Description
5 8002 8710	Tensioning chain, length 950 mm



## CHAIN TENSIONERS FOR TENSIONING CHAIN

ORDER NO.	Pos.	Description
5 8003 8300	1	Chain tensioner small
9 4902 0100	2	Chain lock for chain tensioner small for type 5 8003 8300
5 8002 8400	3	Chain tensioner large

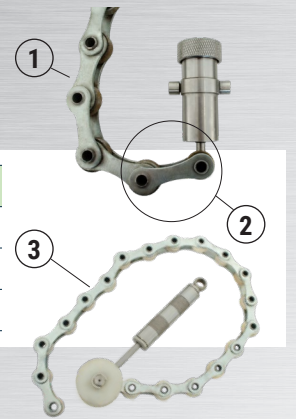

## FEEDING PIPES

ORDER NO.	Pos.	Description
5 8002 9500	1	Feeding pipe
5 8010 9500	2	Feeding pipe, angled at 90° for narrow spaces

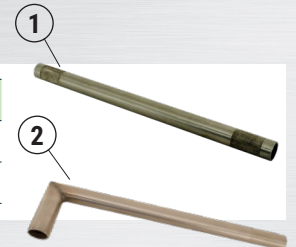

## TOOL SET

ORDER NO.	Description
5 8002 9200	Tool set



## CARRYING CASE

ORDER NO.	Description
5 8002 9300	Metal carrying case with trays



## CARBIDE-TIPPED BLADES

ORDER NO.	Disc dia. [mm]	Center dia. [mm]	Cutting depth max. [mm]	For cutting
9 2503 0090	160	30.0	40	Steel, stainless steel from 4 mm wall thickness, plastics, PE, PVC
9 2503 0120	180	30.0	50	
9 2503 0130	200	30.0	60	



## DIAMOND BLADES

ORDER NO.	Disc dia. [mm]	Center dia. [mm]	Cutting depth max. [mm]	For cutting
9 2503 0050	150	22.2	35	Cast iron, ductuile iron, concrete, cement, clay, GRP
9 2503 0100	180	22.2	50	



## BEVELLING CUTTERS

ORDER NO.	Cutter dia. [mm]	Type	For bevelling of	For type
9 2530 7040	100	Cutter 45°	Steel, plastics, PE, PVC	5 8002, 5 8006, 5 8016
9 2530 7060	100	Cutter 60°		
9 2530 7090	100	Cutter 90°		



## ADAPTERS FOR BLADES

ORDER NO.	Pos.	Description	Center dia. [mm]
5 8010 9720	1	Adapter complete	30.0
5 8002 8020	2	Adapter ring	22.2/30.0

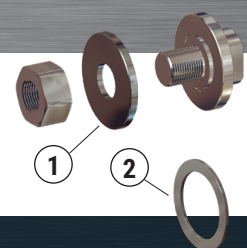

# SYSTEM ACCESSORIES

# SYSTEM ACCESSORIES

## SERVICE UNITS

ORDER NO.	Pos.	Description
9 2406 0260	1	Portable service unit with pressure regulator 3/4"
9 2406 0650	2	Portable service unit with protection housing and pressure regulator 3/4"

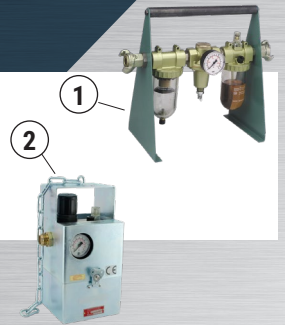

## WATER TANK

ORDER NO.	Description
5 8002 9100	Water tank 10 l



## MULTI-OIL SPRAY

ORDER NO.	Description
9 9902 0120	Multi oil for cleaning and protection



More accessories on request.

## SAW RANGE

### BAND SAWS



### SABRE SAWS



### CHAIN SAWS



### RECIPROCATING SAWS



### CIRCULAR SAWS



### PIPE CUTTING MACHINES



0220E1